



Installing A Weldless Spigot In Your Cooler

Getting Started:

Below is a list of the parts that come with your Weldless Spigot Kit (WL301) as well as a list of the tools needed to best complete your installation. Each tool and part has a number or a letter associated with it to help aid in the installation process. We recommend reading through the process and getting familiar with the parts and tools prior to getting started. Good luck and happy brewing!

Tools & Parts:

- 1 Half-Round Hand File
- 2 Black Felt Tip Pen
- 3 10" Crescent Wrench x 2
- 4 Weldless Spigot Kit (WL301)
 - a barb, ball valve, & bulkhead
 - b red rubber gasket
 - c stainless washer
 - d lock nut



Instructions:

Step One — Remove stock spigot from your 10 gallon Rubbermaid™ Cooler by holding the inside nut and unscrewing the front of the spigot.



Step Two — Un-thread the lock nut (4d), stainless washer (4c), and red rubber gasket (4b) from your WL301, take the stainless washer (4c), and set it in the indentation on your cooler where the spigot goes.

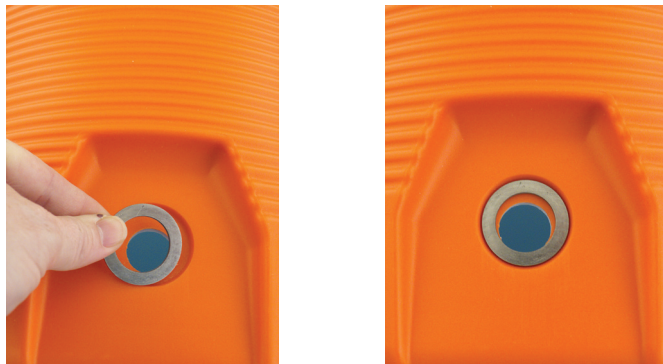

Step Three — Using a black felt tip pen (2), trace inside the stainless washer (4c), creating a template for filing out the hole. When you are done tracing you will have what looks like a crescent moon shape (see far right image).

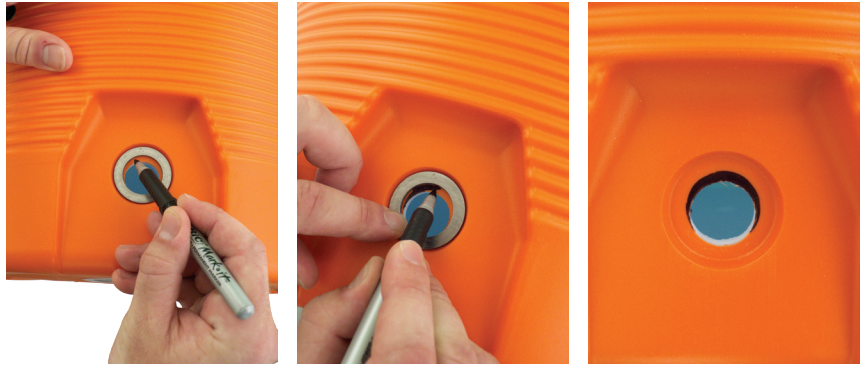

Step Four — Using a general purpose half-round file (1), begin to slowly expand the traced spigot hole. **NOTE:** Be careful to not file out too much, as going outside of the template will result in a non-sealing spigot!



Step Five — Once the hole is filed out and cleaned of debris, push your bulkhead (4a) through the newly expanded spigot hole on the outside of the cooler. On the inside of the cooler, replace the red gasket (4b), then the stainless washer (4c), and finally, thread the lock nut (4d) onto the bulkhead, sealing the system.

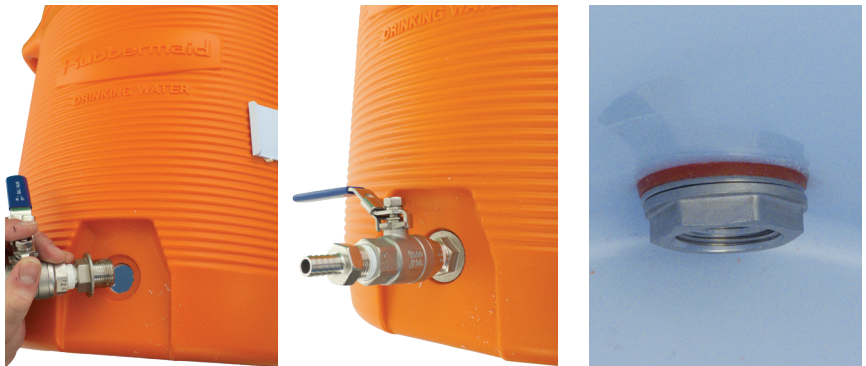

Step Six — At this point, you will want to use a set of crescent wrenches (3) to tighten down on the bulkhead (4a) and lock nut (4d), ensuring a leak proof seal! **NOTE:** We recommend filling your cooler with cool water before first-time use, to confirm that the bulkhead is tight and does not leak! If leaking occurs, tighten down the bulkhead until it doesn't!

